

REVISIONS

1 DSA\_V2 Date 1

THIS DRAWING AND ALL INFORMATION THEREIN IS THE PROPERTY OF THE SOUTHERN BLEACHER COMPANY, TAYLOR & SYFAN AND IS CONFIDENTIAL AND MUST NOT BE MADE PUBLIC OR COPIED. THIS DRAWING IS LOANED SUBJECT TO RETURN UPON DEMAND AND IS NOT TO BE USED DIRECTLY OR INDIRECTLY IN ANY WAY DETRIMENTAL TO OUR INTERESTS.

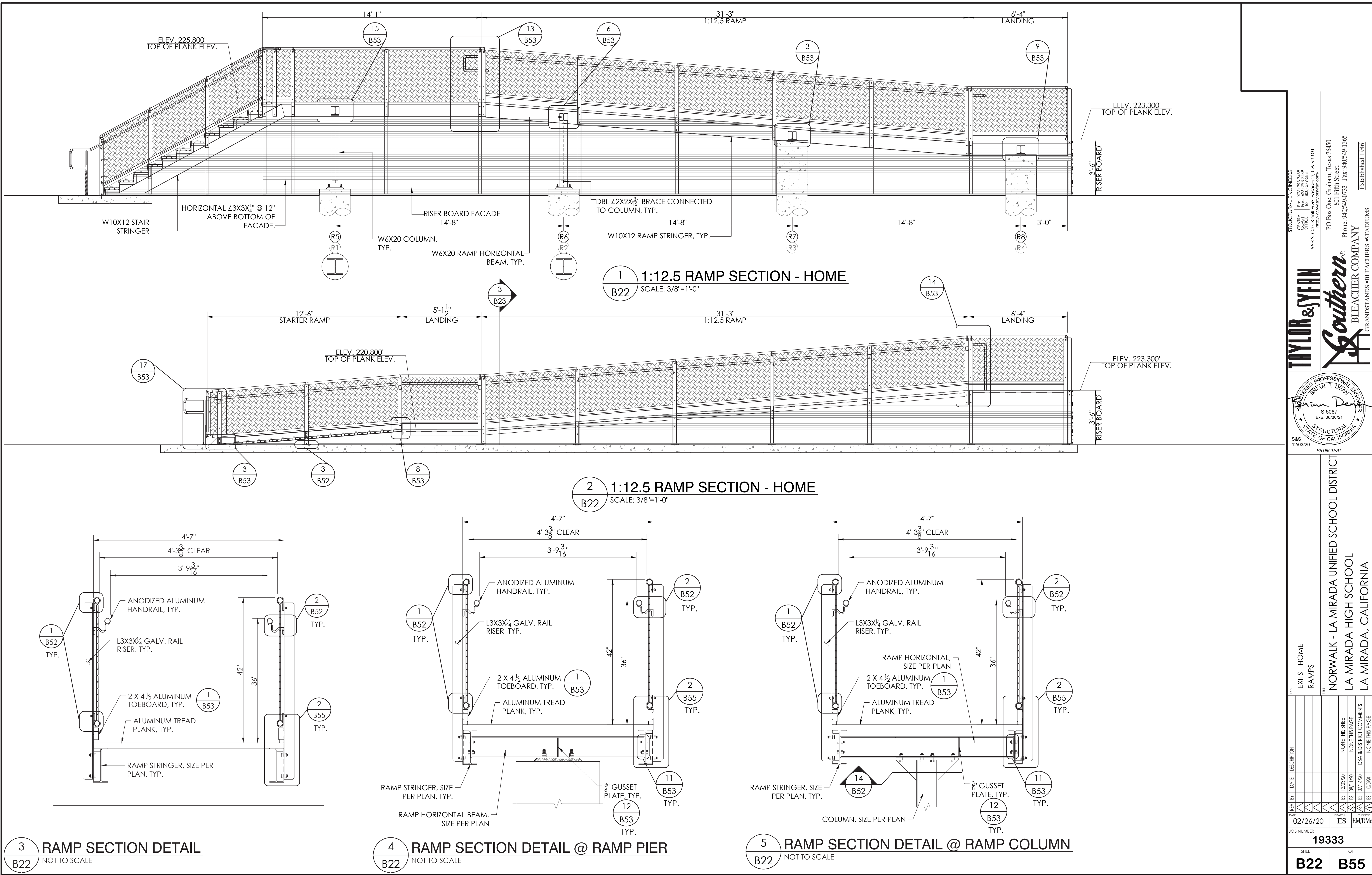

**TAYLOR & SYFAN**  
**Southern BLEACHER COMPANY**  
GRANDSTANDS • BLEACHERS • STADIUMS  
Established 1946

**STRUCTURAL ENGINEERS**  
CORPORATE OFFICE: 5955 CHILMARK AVENUE, SUITE 200, SAN JOSE, CA 95131  
PHONE: (408) 724-2498  
FAX: (408) 724-2497  
OFFICE: 801 FIFTH STREET, SUITE 100, SAN JOSE, CA 95131  
PHONE: (408) 724-2498  
FAX: (408) 724-2497

**PROFESSIONAL DESIGNER**  
BRIAN T. DEAN  
No. 022214  
Exp. 06/30/21  
STRUCTURAL  
STATE OF CALIFORNIA

**PRINCIPAL**  
NORWALK - LA MIRADA UNIFIED SCHOOL DISTRICT  
LA MIRADA HIGH SCHOOL  
LA MIRADA, CALIFORNIA

**REVISIONS**

NO.	DATE	DESCRIPTION
1	02/26/20	ES
2	02/26/20	ES
3	02/26/20	ES
4	02/26/20	ES
5	02/26/20	ES
6	02/26/20	ES
7	02/26/20	ES
8	02/26/20	ES
9	02/26/20	ES
10	02/26/20	ES
11	02/26/20	ES
12	02/26/20	ES
13	02/26/20	ES
14	02/26/20	ES
15	02/26/20	ES
16	02/26/20	ES
17	02/26/20	ES
18	02/26/20	ES
19	02/26/20	ES
20	02/26/20	ES
21	02/26/20	ES
22	02/26/20	ES
23	02/26/20	ES
24	02/26/20	ES
25	02/26/20	ES
26	02/26/20	ES
27	02/26/20	ES
28	02/26/20	ES
29	02/26/20	ES
30	02/26/20	ES
31	02/26/20	ES
32	02/26/20	ES
33	02/26/20	ES
34	02/26/20	ES
35	02/26/20	ES
36	02/26/20	ES
37	02/26/20	ES
38	02/26/20	ES
39	02/26/20	ES
40	02/26/20	ES
41	02/26/20	ES
42	02/26/20	ES
43	02/26/20	ES
44	02/26/20	ES
45	02/26/20	ES
46	02/26/20	ES
47	02/26/20	ES
48	02/26/20	ES
49	02/26/20	ES
50	02/26/20	ES
51	02/26/20	ES
52	02/26/20	ES
53	02/26/20	ES
54	02/26/20	ES
55	02/26/20	ES
56	02/26/20	ES
57	02/26/20	ES
58	02/26/20	ES
59	02/26/20	ES
60	02/26/20	ES
61	02/26/20	ES
62	02/26/20	ES
63	02/26/20	ES
64	02/26/20	ES
65	02/26/20	ES
66	02/26/20	ES
67	02/26/20	ES
68	02/26/20	ES
69	02/26/20	ES
70	02/26/20	ES
71	02/26/20	ES
72	02/26/20	ES
73	02/26/20	ES
74	02/26/20	ES
75	02/26/20	ES
76	02/26/20	ES
77	02/26/20	ES
78	02/26/20	ES
79	02/26/20	ES
80	02/26/20	ES
81	02/26/20	ES
82	02/26/20	ES
83	02/26/20	ES
84	02/26/20	ES
85	02/26/20	ES
86	02/26/20	ES
87	02/26/20	ES
88	02/26/20	ES
89	02/26/20	ES
90	02/26/20	ES
91	02/26/20	ES
92	02/26/20	ES
93	02/26/20	ES
94	02/26/20	ES
95	02/26/20	ES
96	02/26/20	ES
97	02/26/20	ES
98	02/26/20	ES
99	02/26/20	ES
100	02/26/20	ES

**22" X 34" (11x17 = 1/2 indicated scale)**



NORWALK LA MIRADA UNIFIED SCHOOL DISTRICT  
**LA MIRADA HIGH SCHOOL NEW FOOTBALL STADIUM PROJECT**  
13520 ADELEA DRIVE, LA MIRADA, CA 90638

DSA # 03-120551



NAC NO. 161-19015  
DATE 12/10/2020

EXITS-HOME  
RAMPS

**B22**